

2017 AST  
SURRY COUNTY

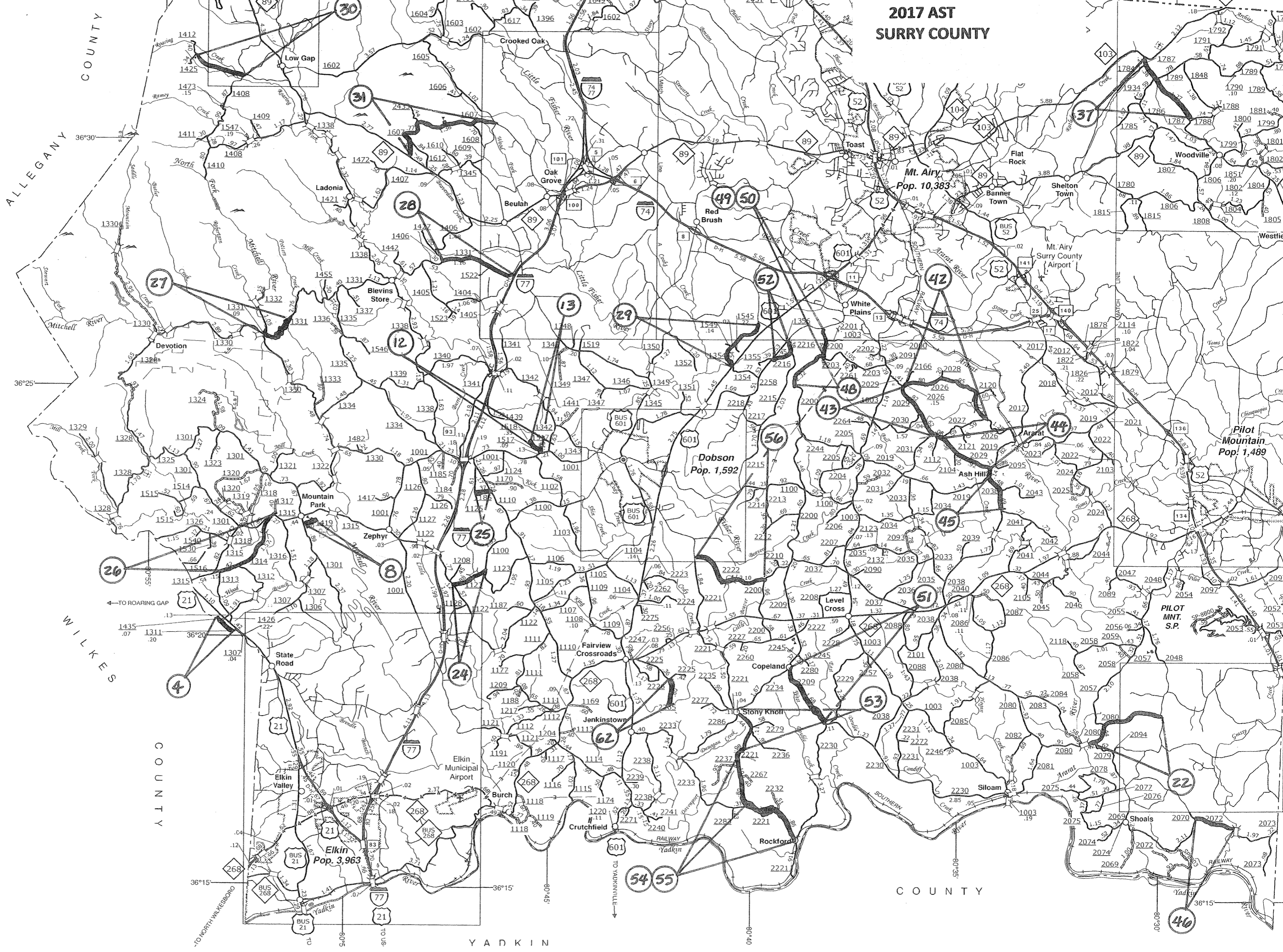

Westfield Friends Cemetery

ALLEGANY COUNTY

WILKES

TOKES COUNTY

YADKIN

COUNTY

46

PILOT MNT. S.P.

Pilot Mountain  
Pop. 1,489

Mt. Airy  
Pop. 10,383

Dobson  
Pop. 1,592

Elkin  
Pop. 3,963

1920

1831

1832

1833

1834

1812

1835

1837

36°30'

36°25'

← TO ROARING GAP

36°20'

36°15'

36°15'

36°15'

80°45'

80°40'

80°30'

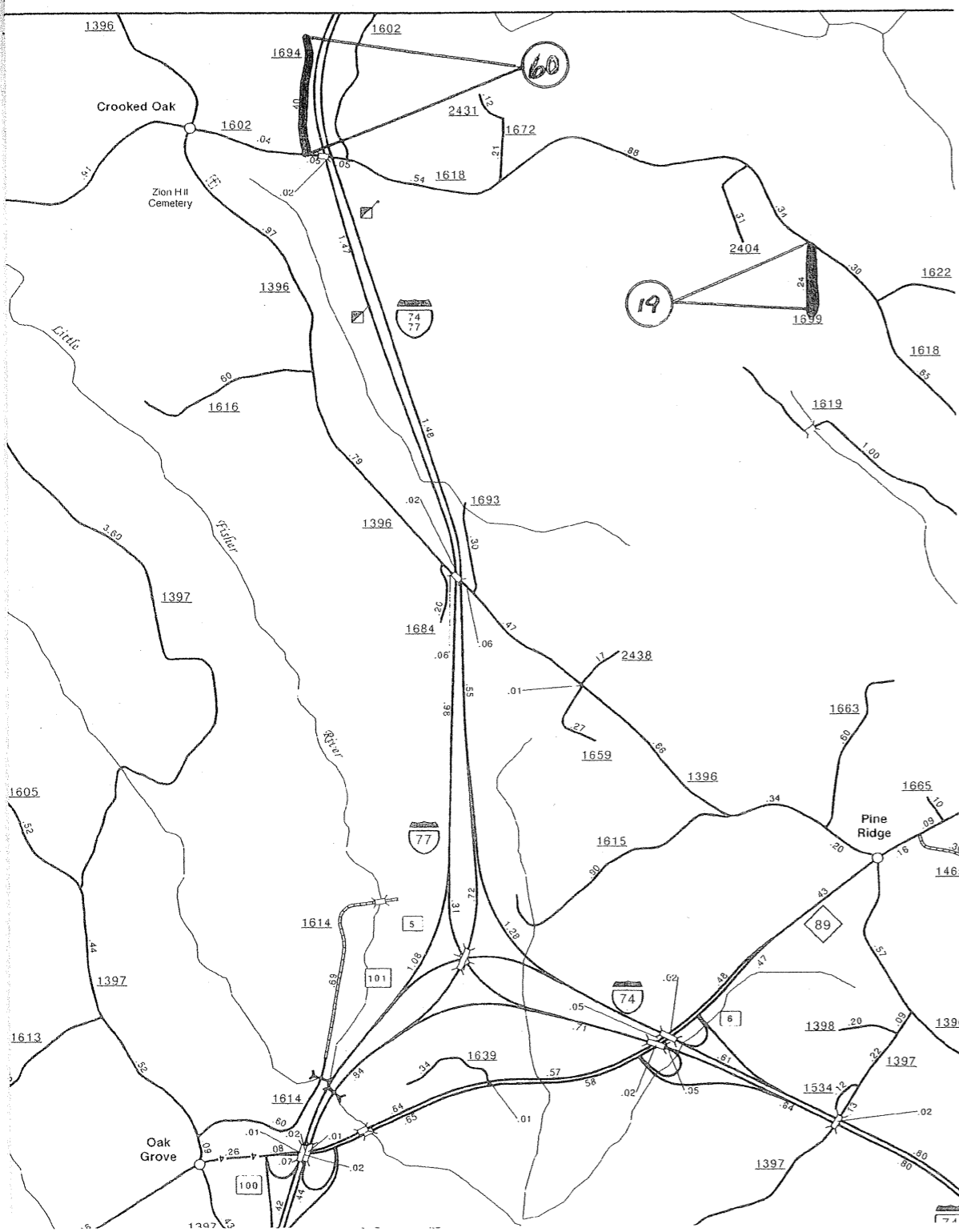

2017 AST  
SURRY COUNTY

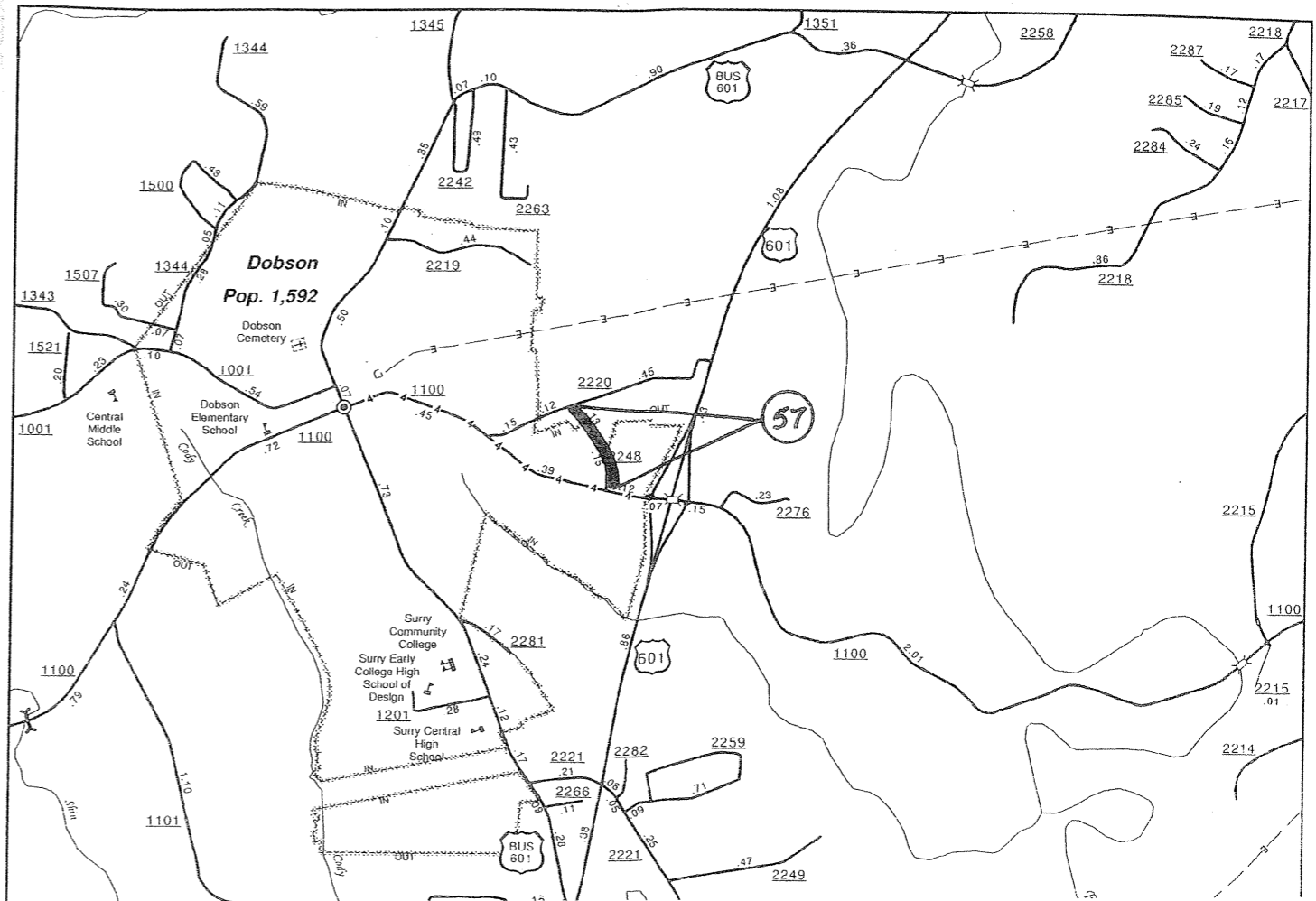
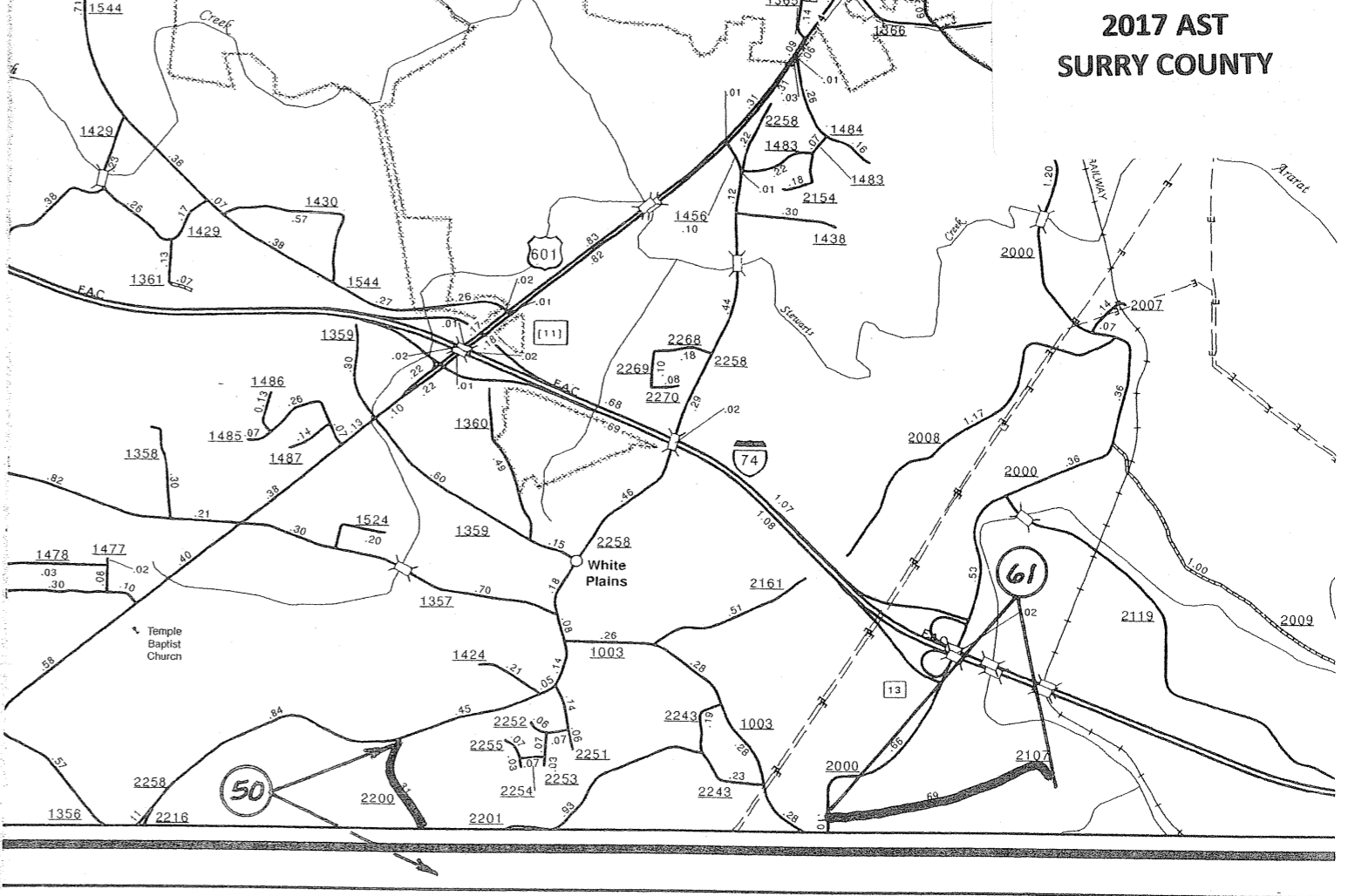

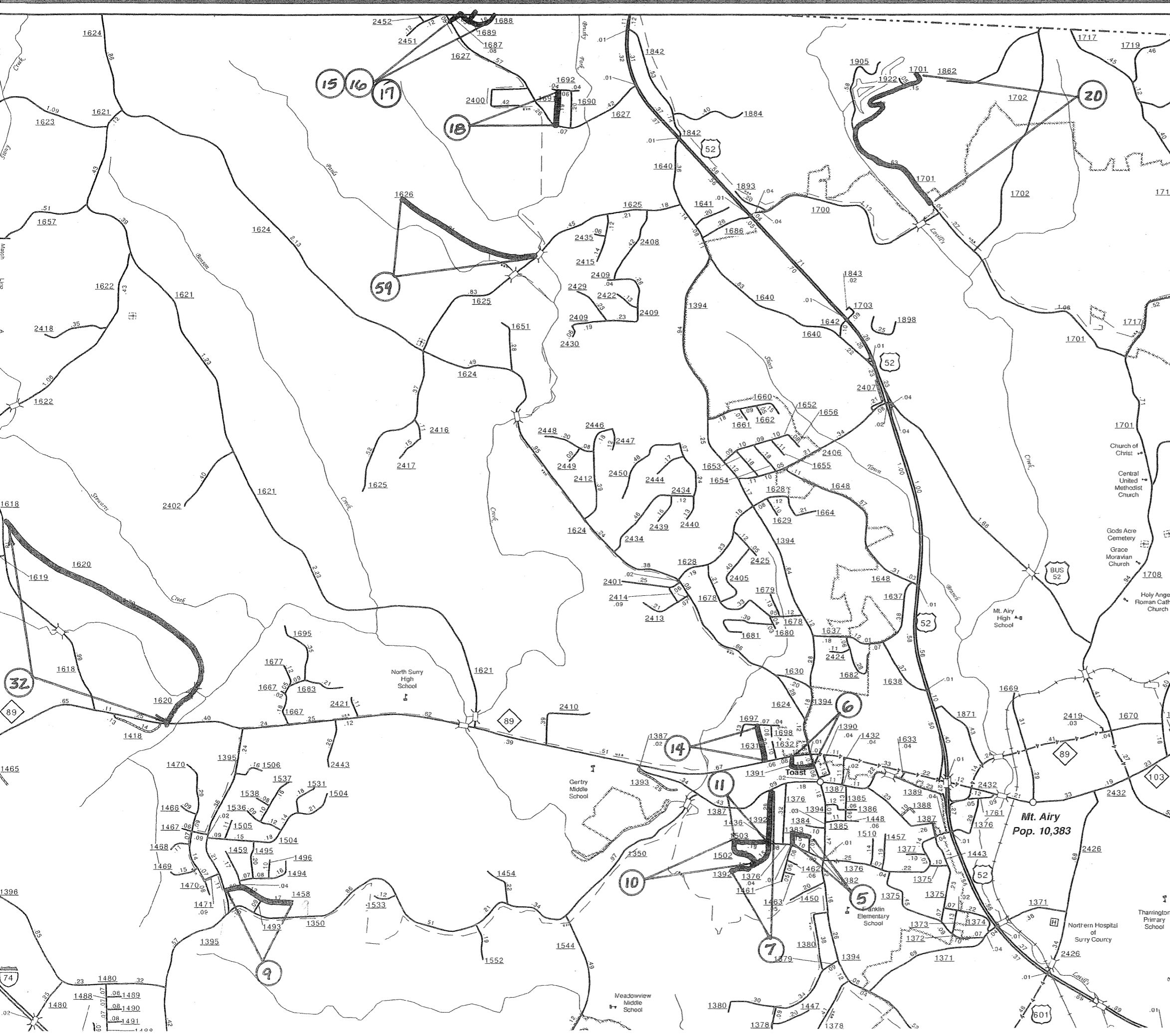

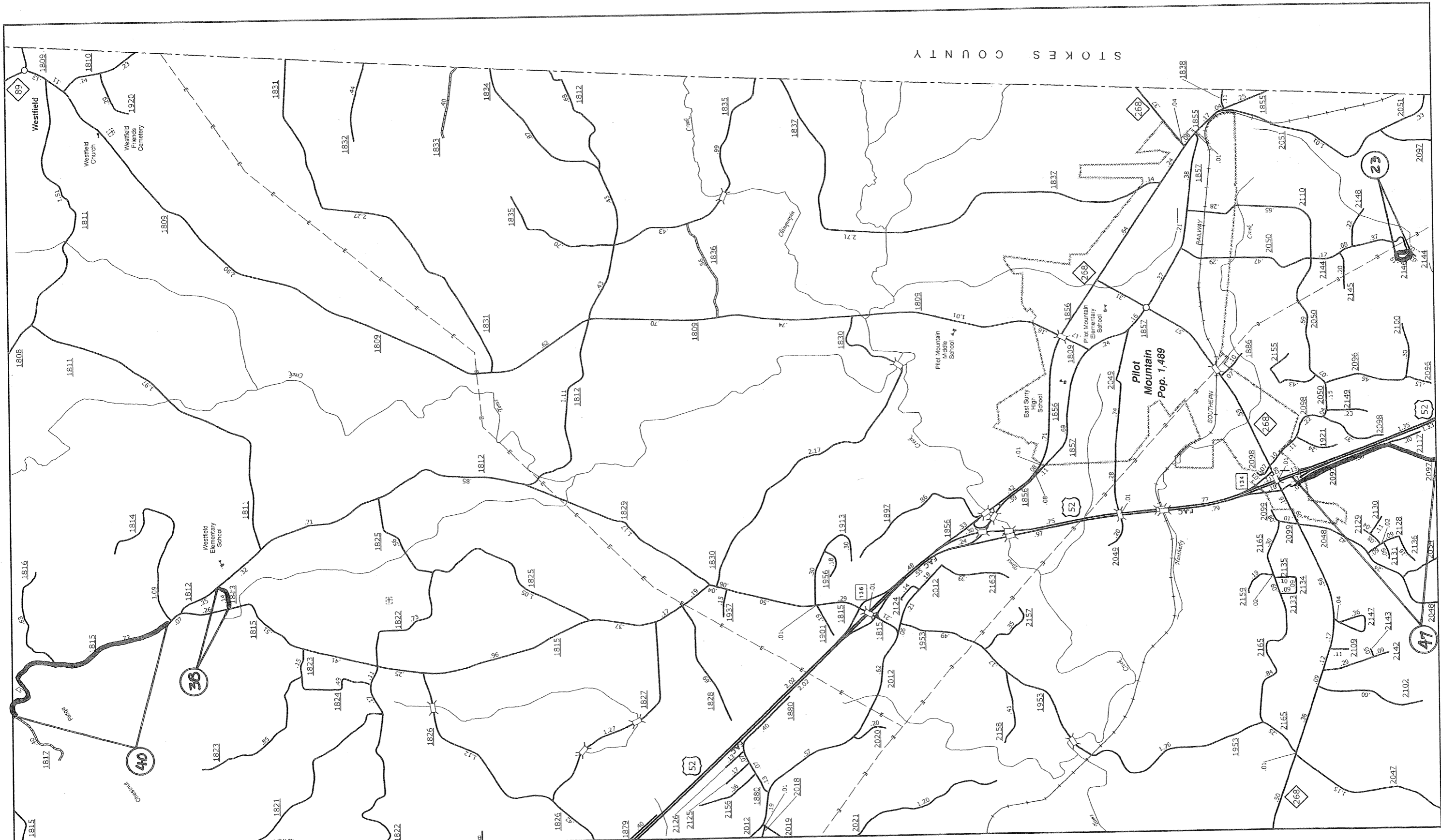

Pilot Mountain and Vicinity

ALLEGANY COUNTY

WILKES

STOKES COUNTY

← TO SPA

← TO F

20

36

40

52

52

47

23

52

Pilot Mountain  
Pop. 1,489

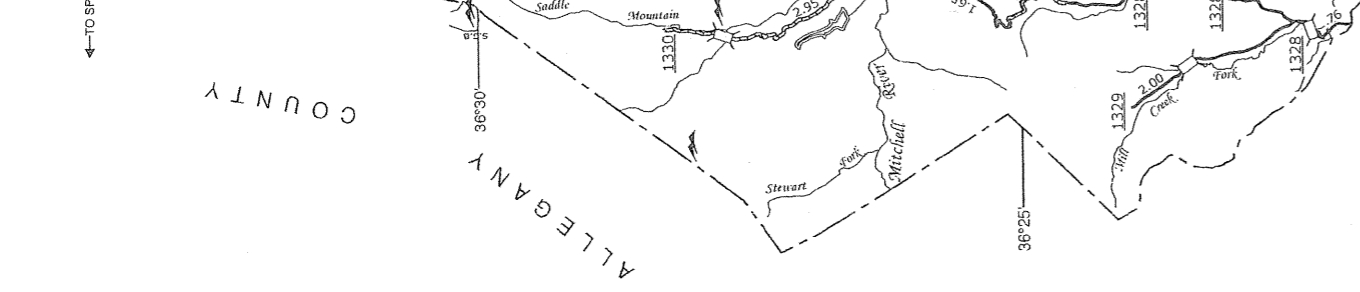



2017 AST  
SURRY COUNTY

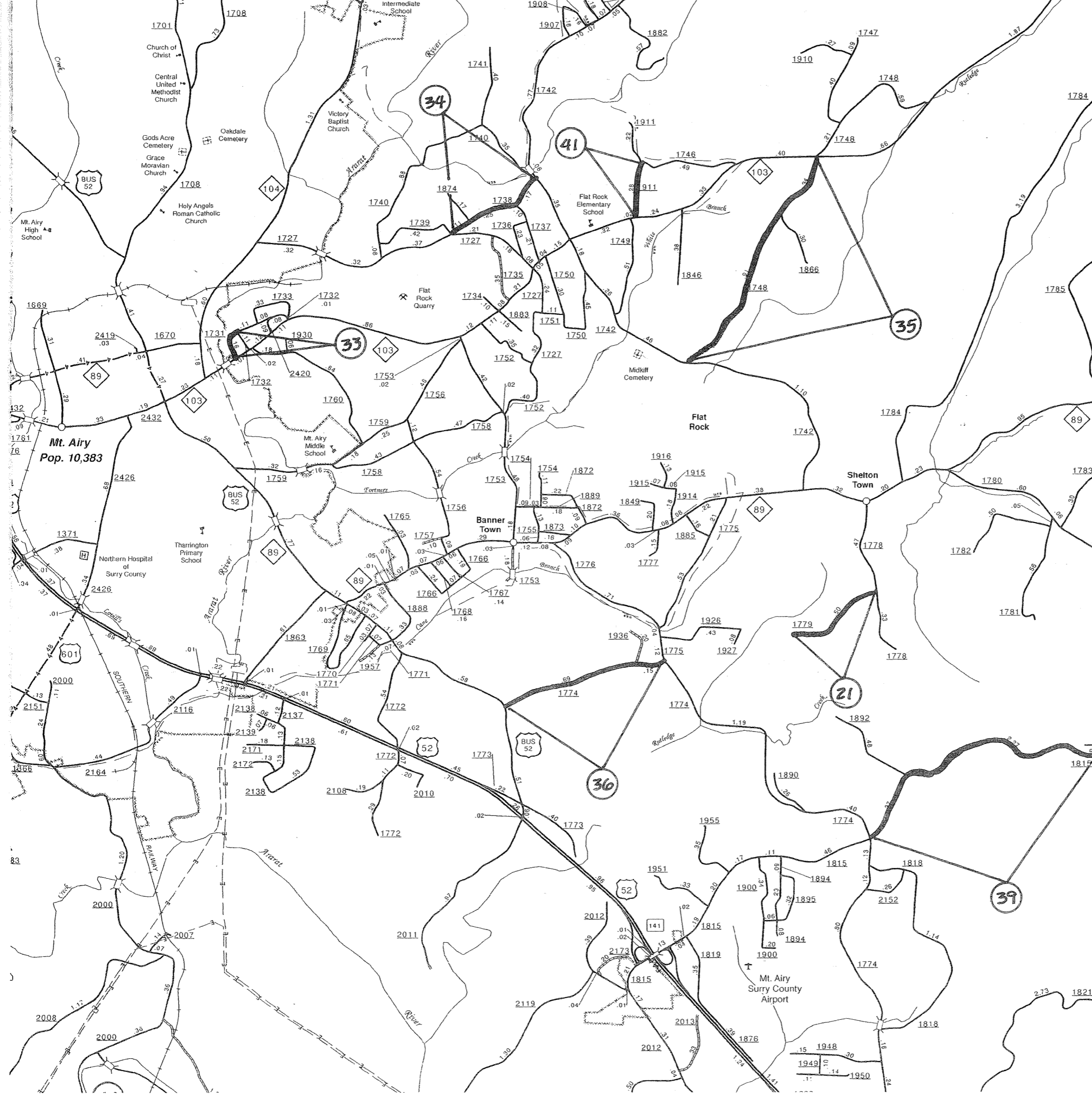

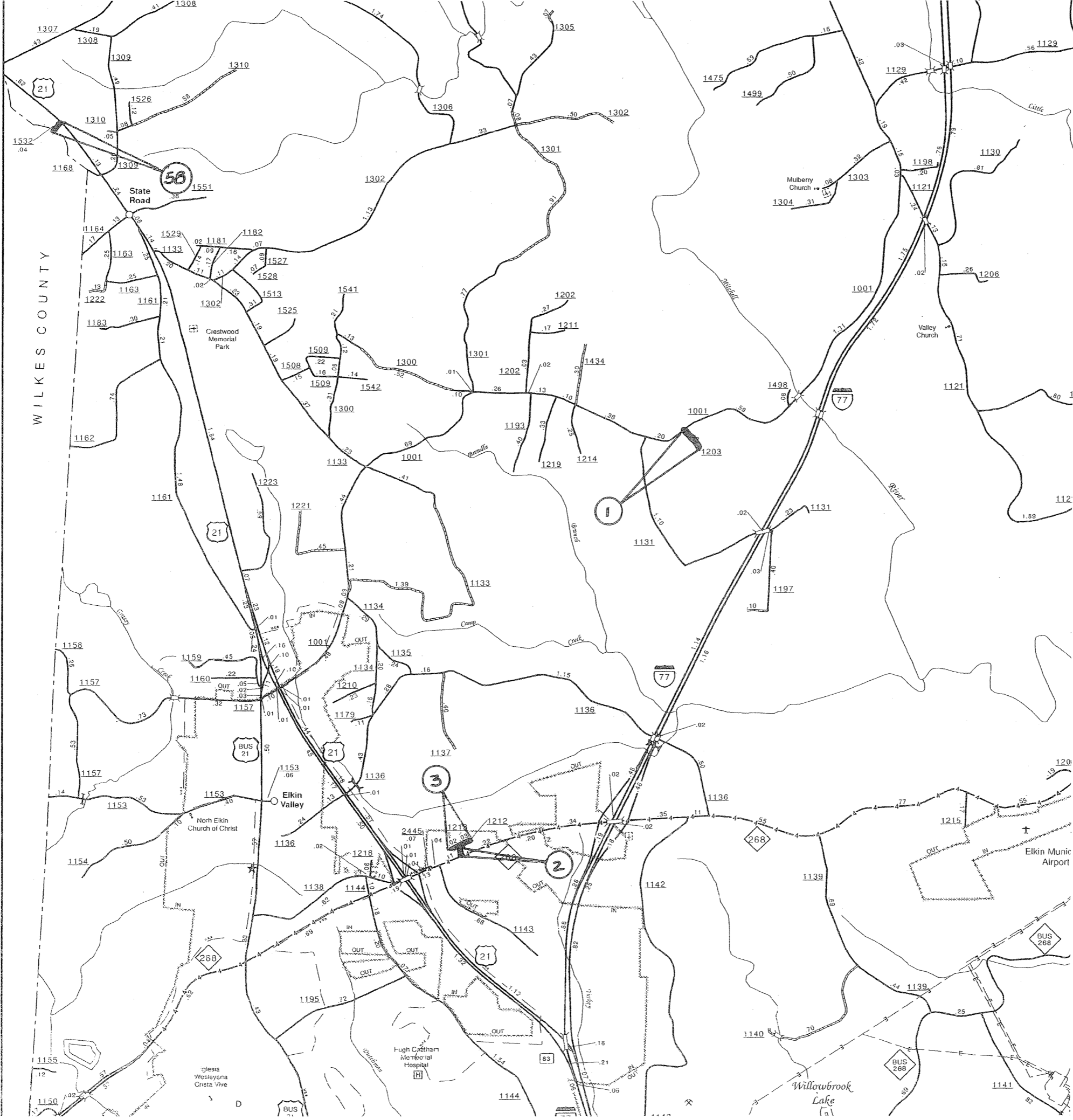

8/17/99

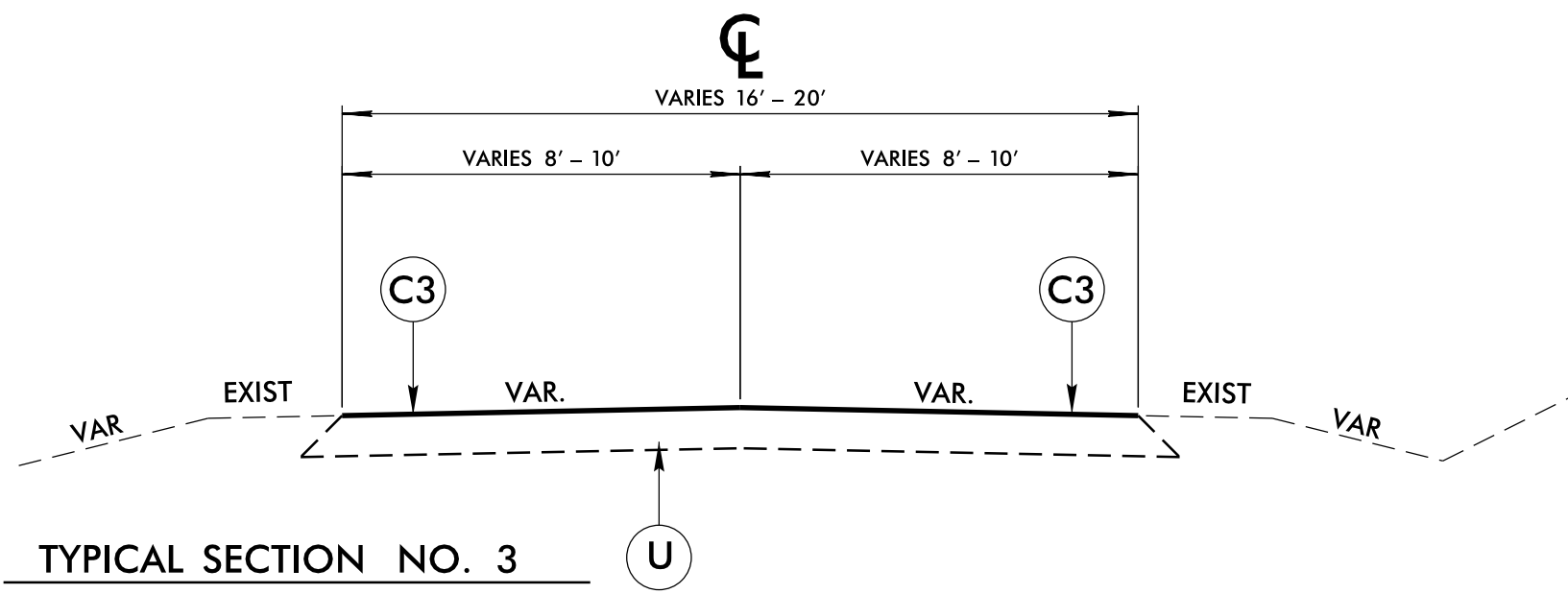
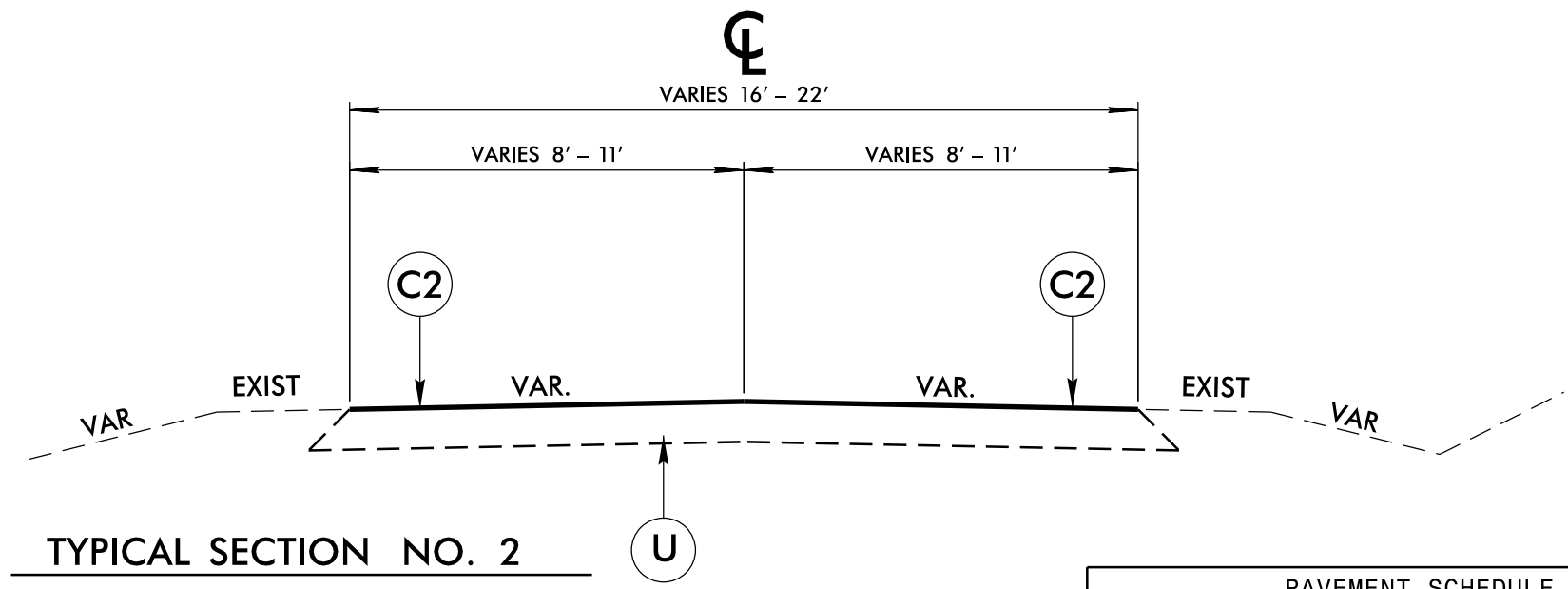
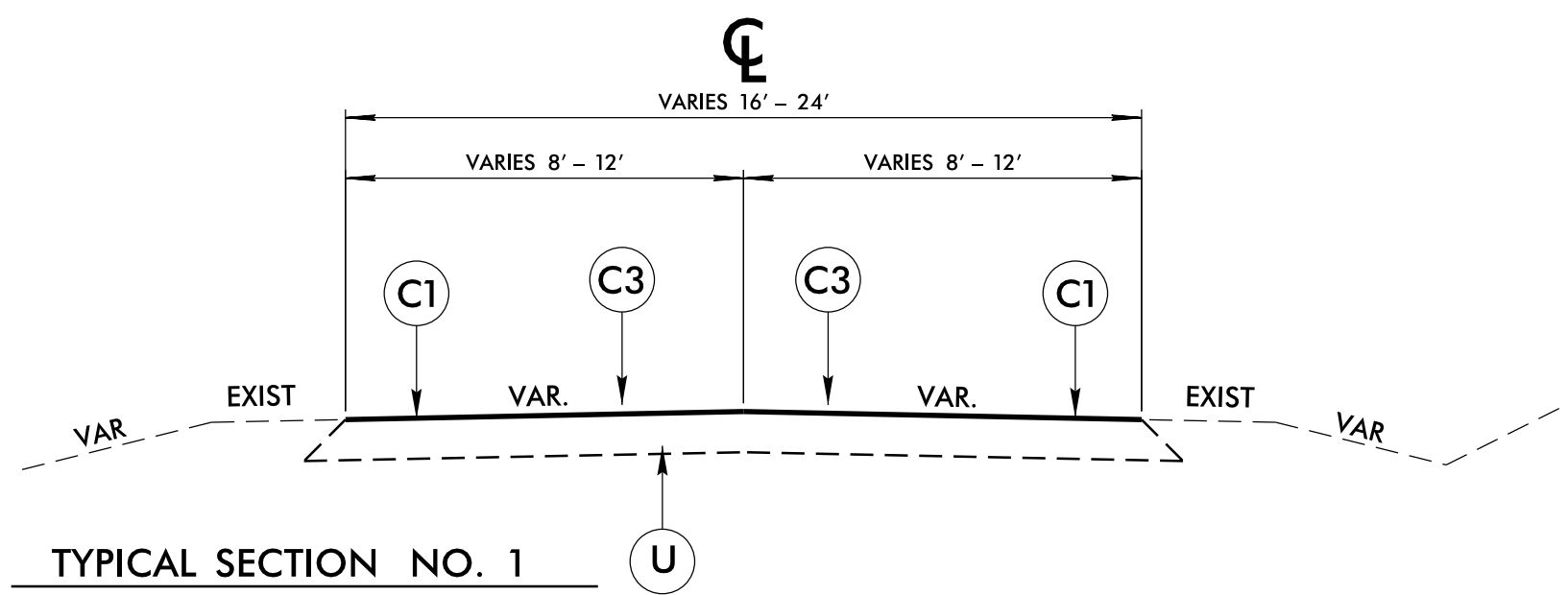

PAVEMENT SCHEDULE	
C1	PROP. ASPHALT SURFACE TREATMENT, FOG SEAL
C2	PROP. ASPHALT SURFACE TREATMENT, TRIPLE SEAL
C3	PROP. ASPHALT SURFACE TREATMENT, DOUBLE SEAL
U	EXISTING PAVEMENT

**SURRY COUNTY  
ASPHALT SURFACE TREATMENT  
RESURFACING**

DIVISION II

REVISIONS	INT.	DATE

N.C. DEPARTMENT of TRANSPORTATION  
DIVISION of HIGHWAYS  
DIVISION ELEVEN

SCALE: N/A DATE: 08/2016

PREPARED BY: J. L. LAWS

REVIEWED BY:

REVIEWED BY:

PROJECT NO.	SHEET NO.	TOTAL NO.
2017CPT.11.15.20862		

## SUMMARY OF QUANTITIES

PROJECT NO	COUNTY	MAP NO	ROUTE	DESCRIPTION	TYP NO	LANES	LANE TYPE	LENGTH M	WIDTH FT	ASPHALT SURFACE TREATMENT, DOUBLE SEAL SY	ASPHALT SURFACE TREATMENT, FOGSEAL SY	ASPHALT SURFACE TREATMENT, TRIPLE SEAL SY	EMULSION FOR ASPHALT SURFACE TREATMENT GAL	4413000000-E WORK ZONE ADVANCE/GENERAL WARNING SIGNING SF	4457000000-N TEMPORARY TRAFFIC CONTROL LS	4810000000-E 4" WHITE PAINT LF	4810000000-E 4" YELLOW PAINT LF	4835000000-E 24" WHITE PAINT LF	4840000000-N PAINT M&G SCHOOL EA
2017CPT.11.15.20862	Surry	1	SR 1203	FROM SR 1001 TO END MAINT	1	2	2WU	0.13	20	1,525	1,525		1,068	64	1.00				
2017CPT.11.15.20862	Surry	2	SR 1212	FROM NC 268 TO SR 1213	1	2	2WU	0.07	16	657	657		460	64	*				
2017CPT.11.15.20862	Surry	3	SR 1213	FROM END MAINT TO END MAINT	1	2	2WU	0.05	16	669	669		469	16	*				
2017CPT.11.15.20862	Surry	4	SR 1311	SR 1307 TO DEAD END	1	2	2WU	0.2	16	1,877	1,877		1,314	128	*				
2017CPT.11.15.20862	Surry	5	SR 1383	FROM SR 1382 TO SR 1376	1	2	2WU	0.15	18	1,584	1,584		1,109	64	*				
2017CPT.11.15.20862	Surry	6	SR 1391	FROM NC 89 TO SR 1394	1	2	2WU	0.18	18	1,901	1,901		1,331	104	*				
2017CPT.11.15.20862	Surry	7	SR 1392	FROM SR 1387 TO END MAINT	1	2	2WU	0.56	20	6,771	6,771		4,740	144	*				
2017CPT.11.15.20862	Surry	8	SR 1419	FROM SR 1301 TO DEAD END	1	2	2WU	0.2	16	2,077	2,077		1,454	64	*				
2017CPT.11.15.20862	Surry	9	SR 1458	FROM SR 1395 TO DEAD END	1	2	2WU	0.37	20	4,841	4,841		3,390	112	*				
2017CPT.11.15.20862	Surry	10	SR 1502	FROM SR 1503 TO SR 1392	1	2	2WU	0.2	18	2,112	2,112		1,478	16	*				
2017CPT.11.15.20862	Surry	11	SR 1503	FROM SR 1502 TO SR 1392	1	2	2WU	0.19	18	2,006	2,006		1,404		*				
2017CPT.11.15.20862	Surry	12	SR 1517	FROM SR 1001 TO SR 1518	1	2	2WU	0.09	16	845	845		591	64	*				
2017CPT.11.15.20862	Surry	13	SR 1518	FROM SR 1517 TO EOM	1	2	2WU	0.35	16	3,485	3,485		2,440		*				
2017CPT.11.15.20862	Surry	14	SR 1631	FROM NC 89 TO SR 1697	1	2	2WU	0.2	18	2,112	2,112		1,478	64	*				
2017CPT.11.15.20862	Surry	15	SR 1687	FROM SR 1627 TO SR 1688	1	2	2WU	0.08	24	1,126	1,126		788	64	*				
2017CPT.11.15.20862	Surry	16	SR 1688	FROM EOM TO EOM	1	2	2WU	0.29	20	3,603	3,603		2,522		*				
2017CPT.11.15.20862	Surry	17	SR 1689	FROM SR 1688 TO EOM	1	2	2WU	0.1	20	1,173	1,173		821		*				
2017CPT.11.15.20862	Surry	18	SR 1691	FROM SR 1627 TO SR 1692	1	2	2WU	0.19	18	2,006	2,006		1,404	64	*				
2017CPT.11.15.20862	Surry	19	SR 1699	FROM SR 1618 TO EOM	1	2	2WU	0.24	16	2,253	2,253		1,577	64	*				
2017CPT.11.15.20862	Surry	20	SR 1701	FROM SR 1700 TO EOM	1	2	2WU	1.3	18	14,328	14,328		10,030	96	*	27,976	27,456		
2017CPT.11.15.20862	Surry	21	SR 1779	FROM SR 1778 TO EOM	1	2	2WU	0.5	20	5,867	5,867		4,107	64	*				
2017CPT.11.15.20862	Surry	22	SR 2080	FROM SR 2083 TO SR 2048	1	2	2WU	2.24	22	29,511	29,511		20,658	272	*	48,205	47,308		
2017CPT.11.15.20862	Surry	23	SR 2146	FROM SR 2144 TO SR 2144	1	2	2WU	0.19	20	2,229	2,229		1,560	40	*				
2017CPT.11.15.20862	Surry	24	SR 1123	FROM SR 1122 TO SR 1100	2	2	2WU	0.88	18			9,493	7,215	160	*	18,938	18,584		
2017CPT.11.15.20862	Surry	25	SR 1186	FROM SR 1110 TO SR 1125	2	2	2WU	0.37	20			4,341	3,299	136	*	7,962	7,816		
2017CPT.11.15.20862	Surry	26	SR 1314	FROM SR 1315 TO SR 1315	2	2	2WU	2.14	20			25,509	19,387	216	*	46,053	45,196		
2017CPT.11.15.20862	Surry	27	SR 1331	FROM SR 1330 TO MP 1.40	2	2	2WU	1.4	18			14,984	11,388	136	*	30,128	29,568		
2017CPT.11.15.20862	Surry	28	SR 1331	FROM SR 1406 TO SR 1404	2	2	2WU	1.65	18			17,624	13,394	136	*	35,508	34,848		
2017CPT.11.15.20862	Surry	29	SR 1354	FROM US 601 TO SR 1356	2	2	2WU	1.5	18			16,240	12,342	184	*	32,280	31,680		
2017CPT.11.15.20862	Surry	30	SR 1412	FROM SR 1408 TO SR 1425	2	2	2WU	1.22	20			14,515	11,031	160	*	26,254	25,768		
2017CPT.11.15.20862	Surry	31	SR 1607	FROM NC 89 TO SR 1605	2	2	2WU	3.02	20			36,035	27,386	304	*	64,990	63,784	360	24
2017CPT.11.15.20862	Surry	32	SR 1620	FROM SR 1618 TO NC 89	2	2	2WU	1.7	20			19,947	15,159	192	*	36,584	35,904		



															PROJECT NO.		SHEET NO.	TOTAL NO.	
															2017CPT.11.15.20862				
2017CPT.11.15.20862	Surry	33	SR 1731	FROM SR 1732 TO NC 103	2	2	2WU	0.16	20			1,877	1,427	104	*				
2017CPT.11.15.20862	Surry	34	SR 1738	FROM SR 1727 TO SR 1742	2	2	2WU	0.53	20			6,619	5,030	184	*	11,406	11,192		
2017CPT.11.15.20862	Surry	35	SR 1748	FROM NC 103 TO SR 1742	2	2	2WU	1.25	20			14,867	11,300	192	*	26,900	26,400		
2017CPT.11.15.20862	Surry	36	SR 1774	FROM US 52 BUS TO SR 1775	2	2	2WU	0.84	20			10,056	7,643	160	*	18,077	17,740		
2017CPT.11.15.20862	Surry	37	SR 1787	FROM NC 103 TO SR 1788	2	2	2WU	1.89	18			20,358	15,472	264	*	40,673	39,916		
2017CPT.11.15.20862	Surry	38	SR 1813	FROM SR 1812 TO SR 1815	2	2	2WU	0.14	20			1,643	1,248	128	*	3,013	2,956		
2017CPT.11.15.20862	Surry	39	SR 1815	FROM SR 1774 TO SR 1817	2	2	2WU	3.64	20			43,209	32,839	320	*	78,333	76,876		
2017CPT.11.15.20862	Surry	40	SR 1815	FROM SR 1817 TO SR 1814	2	2	2WU	1.29	18			13,822	10,505	104	*	27,761	27,244		
2017CPT.11.15.20862	Surry	41	SR 1911	FROM NC 103 TO SR 1746	2	2	2WU	0.28	20			3,485	2,649	104	*				
2017CPT.11.15.20862	Surry	42	SR 2026	FROM SR 2029 TO SR 2027	2	2	2WU	2.57	20			30,755	23,374	208	*	55,306	54,280		
2017CPT.11.15.20862	Surry	43	SR 2029	FROM SR 2026 TO SR 2031	2	2	2WU	1.44	22			18,786	14,277	160	*	30,989	30,412		
2017CPT.11.15.20862	Surry	44	SR 2029	FROM SR 2031 TO SR 2019	2	2	2WU	1.54	22			20,276	15,410	144	*	33,141	32,524		
2017CPT.11.15.20862	Surry	45	SR 2038	FROM SR 2019 TO SR 2041	2	2	2WU	0.97	18			10,443	7,937	112	*	20,874	20,488		
2017CPT.11.15.20862	Surry	46	SR 2072	FROM SR 2070 TO BRIDGE	2	2	2WU	1.03	20			12,285	9,337	160	*	22,166	21,752		
2017CPT.11.15.20862	Surry	47	SR 2097	FROM US 52 TO US 52 RAMP	2	2	2WU	1.7	20			20,147	15,311	208	*	36,584	35,904		
2017CPT.11.15.20862	Surry	48	SR 2200	FROM MP 7.0 TO SR 2203	2	2	2WU	1	20			11,933	9,069	80	*	21,520	21,120		
2017CPT.11.15.20862	Surry	49	SR 2200	FROM SR 2203 TO SR 2201	2	2	2WU	0.34	20			4,189	3,184	24	*	7,317	7,180		
2017CPT.11.15.20862	Surry	50	SR 2200	FROM SR 2201 TO SR 2258	2	2	2WU	0.31	20			3,837	2,916	96	*	6,671	6,548		
2017CPT.11.15.20862	Surry	51	SR 2209	FROM SR 2230 TO SR 2234	2	2	2WU	1.68	16			15,770	11,985	216	*	36,154	35,480		
2017CPT.11.15.20862	Surry	52	SR 2216	FROM SR 2258 TO SR 2258	2	2	2WU	0.83	16			7,991	6,073	160	*	17,862	17,528		
2017CPT.11.15.20862	Surry	53	SR 2221	FROM SR 2234 TO BEG 16' PVT	2	2	2WU	1.01	22			13,236	10,059	96	*	21,735	21,332		
2017CPT.11.15.20862	Surry	54	SR 2221	FROM BEG 16' PVT TO SR 2233	2	2	2WU	1.54	22			20,276	15,410	104	*	33,141	32,524		
2017CPT.11.15.20862	Surry	55	SR 2221	FROM SR 2233 TO SR 2230	2	2	2WU	1.63	22			21,238	16,141	160	*	35,078	34,424		
2017CPT.11.15.20862	Surry	56	SR 2222	FROM SR 2221 TO SR 2200	2	2	2WU	2.1	18			22,376	17,006	192	*	45,192	44,352		
2017CPT.11.15.20862	Surry	57	SR 2248	FROM SR 1100 TO SR 2220	2	2	2WU	0.28	20			3,485	2,649	128	*	6,026	5,912		
2017CPT.11.15.20862	Surry	58	SR 1532	FROM WILKES CO TO EOM	3	2	2WU	0.04	16	375			206	64	*				
2017CPT.11.15.20862	Surry	59	SR 1626	FROM SR 1625 TO EOM	3	2	2WU	0.81	18	8,754			4,815	64	*				
2017CPT.11.15.20862	Surry	60	SR 1694	FROM SR 1602 TO EOM	3	2	2WU	0.4	20	4,893			2,691	64	*				
2017CPT.11.15.20862	Surry	61	SR 2107	FROM SR 2000 TO EOM	3	2	2WU	0.69	18	7,486			4,118	64	*				
2017CPT.11.15.20862	Surry	62	SR 2265	FROM SR 2225 TO EOM	3	2	2WU	0.6	18	6,536			3,595	40	*				
<b>TOTAL FOR PROJ NO. 2017CPT.11.15.20862</b>							<b>54.48</b>			<b>122,602</b>	<b>94,558</b>	<b>511,647</b>	<b>470,470</b>	<b>7,296</b>	<b>1</b>	<b>1,010,797</b>	<b>991,996</b>	<b>360</b>	<b>24</b>
<b>GRANDTOTAL</b>							<b>54.48</b>			<b>122,602</b>	<b>94,558</b>	<b>511,647</b>	<b>470,470</b>	<b>7,296</b>	<b>1</b>	<b>1,010,797</b>	<b>991,996</b>	<b>360</b>	<b>24</b>

# SIGNING FOR RESURFACING PROJECTS

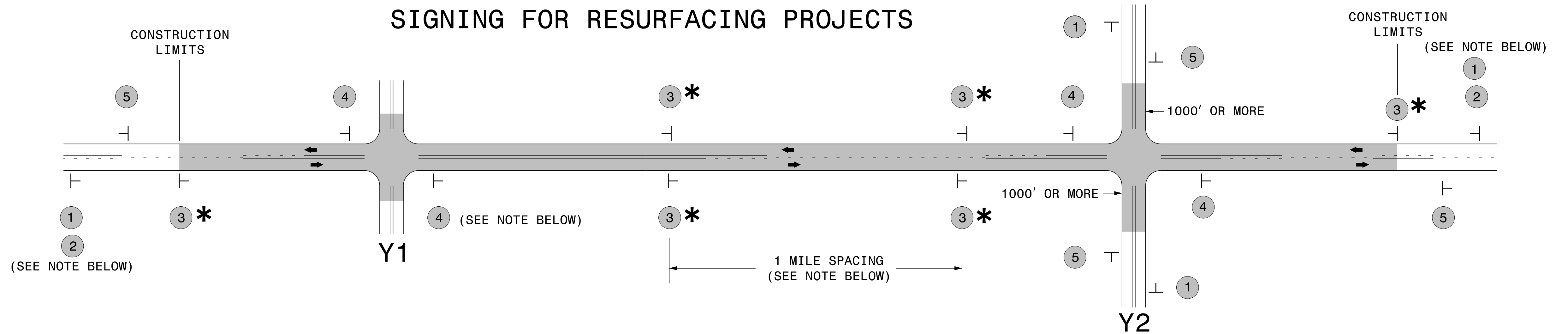

LEGEND	
┆	STATIONARY SIGN
←	DIRECTION OF TRAFFIC FLOW

## MAINLINE (-L-) SIGNING

## -Y- LINE SIGNING

SIGNING NOTES AND PLACEMENT PER DIRECTION	MAINLINE (-L-) SIGNING		-Y- LINE SIGNING	
	1	 W20-1 48" X 48"	PLACE 1000' PRIOR TO BEGINNING OF CONSTRUCTION LIMITS. ONLY USED ON -Y- LINES IF RESURFACING LIMITS EXTEND 1000' ALONG -Y- LINE.	<p>NO REQUIRED STATIONARY SIGNING FOR THE FOLLOWING -Y- LINE CONDITIONS:</p> <ol style="list-style-type: none"> <li>1) LESS THAN 1000' OF RESURFACING ALONG -Y- LINE</li> <li>2) SUBDIVISION ROADS</li> <li>3) DEAD END ROADS</li> </ol> <p>WHEN PAVING/CONSTRUCTION ACTIVITIES PROCEED ACROSS AN UNSIGNED -Y- LINE, ADVANCE WARNING PORTABLE SIGNS SHALL BE USED ALONG THE -Y- LINE AS SHOWN BELOW. REMOVE UPON COMPLETION OF WORK.</p> <div style="display: flex; justify-content: space-around;"> <div>             W20-1            48" X 48"         </div> <div>             W20-7 A            48" X 48"         </div> </div> <p>PLACED 500' IN ADVANCE OF FLAGGER. PLACED 250' IN ADVANCE OF FLAGGER.</p>
	2	 W7-3aP 24" X 18"	#2 SIGN ONLY USED WHEN RESURFACING LIMITS ARE 2 OR MORE MILES IN LENGTH. ROUND UP TO NEXT WHOLE NUMBER. (NO FRACTIONAL OR DECIMAL NUMBERS)	
	3 *	 SP 13107 48" X 48"	PLACE INITIALLY AT THE CONSTRUCTION LIMITS AND SPACED 1 MILE APART THEREAFTER. IF NO -Y- LINES EXIST, PLACE 2ND SET 1/2 MILE FROM THE CONSTRUCTION LIMITS AND THEN SPACE 1 MILE THEREAFTER.	
	4	 SP 13106 48" X 48"	THESE ARE FOR -Y- LINES THAT ARE "THROUGH" ROADWAYS. DEAD END AND SUBDIVISION ROADS ARE NOT "THROUGH" ROADWAYS. INSTALL 500' +/- FROM EACH -Y- LINE APPROACH AS SHOWN ABOVE. FOR MULTIPLE -Y- LINES THAT ARE SEPARATED BY 0.25 MILES OR LESS, TREAT AS A SINGLE UNIT AND INSTALL WITHIN 500' OF EACH APPROACH. A MAXIMUM OF 2 SIGN SETS PER MILE. DO NOT INSTALL WHEN -Y- LINES ARE WITHIN 0.5 MILES FROM "END ROAD WORK" SIGN.	
5	 G20-2 A 48" X 24"	PLACE 500' FOLLOWING THE END OF CONSTRUCTION LIMITS.		

### \* SIGNING FOR ASPHALT SURFACE TREATMENTS (ONLY)

SUBSTITUTE LOW/SOFT SHOULDER SIGNS BY ALTERNATING THE FOLLOWING TWO SIGNS: STARTING WITH "UNMARKED PAVEMENT AHEAD" (SP 06026) FOLLOWED BY "LOOSE GRAVEL" (W8-7).

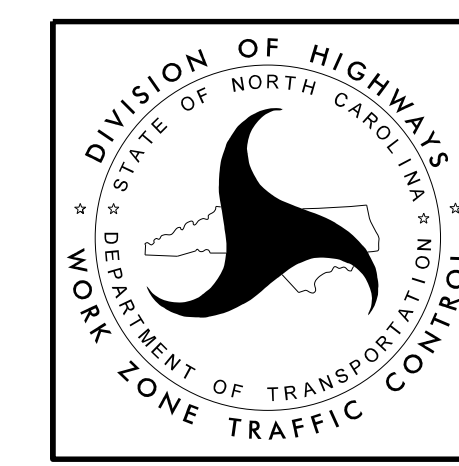

RESURFACING ADVANCE WARNING SIGNS FOR RURAL AND SUBURBAN 2 LANE ROADWAYS

6/3/2014 S:\T\U\WZTC\Apps\WorkZoneGeneral\ExternalWebPage\DesRes\Resurfacing\Resurfacing\_AdvWarn\_2Ln.dgn User:rmgarr